



Installation recommendations

1-Pre-Installation

The recommendations provided in the bulletin represent our best judgment based on our experience with normal applications. Any deviation from these recommended procedures shall be at the sole risk of the installers.

1.1.-Preliminary inspections

Carefully inspect all panels. Due to the texture and manufacturing techniques, some panels may have minor variations in the consistency and color pattern.

If a panel is defective, notify to Stabilite Europa or at your distributor, failure to do so shall be at the sole risk of the installer. notify the Stabilite Europa or your distributor, otherwise it will be under the exclusive risk of the installer

1.2.-Toold required

Table saw or circular saw with fine-tooth blade, caulking gun, rule/tape, drill, file, hammer, plumb line/level, ridge/support.

1.3.-Cleaning

Use a damp cloth, mild soap or detergent to clean panels. Use mineral spirits to remove excess adhesive before it dries. Do not use abrasive cleaners

2- Installation

2.1.-Installation tips

1) Allow the laminates to acclimate to the living room environment before installation. After unpacking, place the laminates in the room where they will be installed for at least 48 hours before installation

2) Install the laminates when the temperature of the room and the material is approximately 21°C.

3) Application is recommended over a solid backing, such as drywall or plywood.

Surface to be covered must be clean, dry, solid, straight, and free from drywall dust, bumps, projections, loose plaster, loose paint, or any unsealed joint compound wider than 76,2 mm. For seams with excessive joint compound wider than 76,2 mm, seal drywall joint using a 50/50 mixture of latex paint and water applied lightly over the drywall compound only

4) Maintain plumb vertical edges with plumb lines or level

5) Do not position FRP Panel joints directly over drywall or plywood joints.

6) Cut FRP Panels face up using a table saw or face down using a circular saw.

7) For grooved Panels, proper panel orientation is required to ensure groove alignment.

2.2.-High Humidity Areas

In wet or high humidity areas, the molding profiles must surround all the laminates and must be properly sealed with a continuous silicone sealant cord to ensure a tight seal

2.3.- Installation

2.3.1.-Installation Steps for FRP Trim Molding

Trim Molding must be applied using pin tacks or staples and/or adhesive. Do not pin nails or staple through FRP Panels. Trim Molding should surround all edges of every FRP Panel.

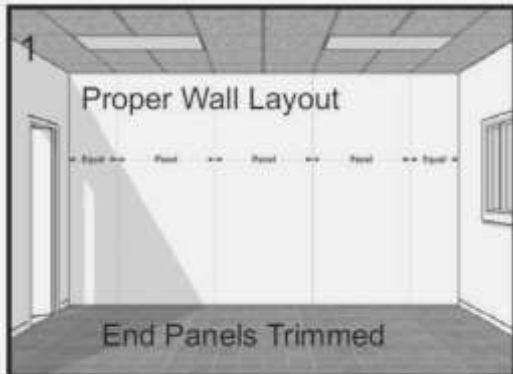

- 1) For a balanced appearance, establish a center line of area to be covered and install Division Trim Molding and work toward corners. (see illustration 1)

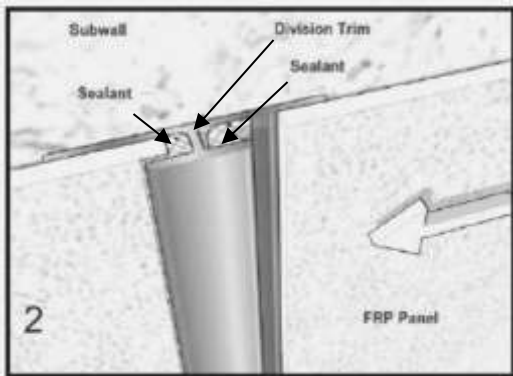

- 2) Do not fit panels too tightly into Trim Molding. Allow at least 1/8" space in all channels for panel expansion after installation is completed. (see illustration 2)

- 3) Where **steam cleaning is required, and high moisture conditions are prevalent**; all Trim Molding and FRP Panels must be sealed with Silicone Sealant to ensure a watertight seal. (see illustrations 3 – 6)
Silicone Sealant is best applied to Trim Molding prior to application to the wall. It is important that a continuous, non-broken bead of sealant is applied. Excess sealant "squeeze-out" should be promptly cleaned off with mineral spirits. It is suggested that a sealant be applied to all exposed edges of molding, electric plates and other covers after installation. Allow 24 hours drying time for sealant. Rough cut FRP Panel edges can be smoothed with sandpaper or a file

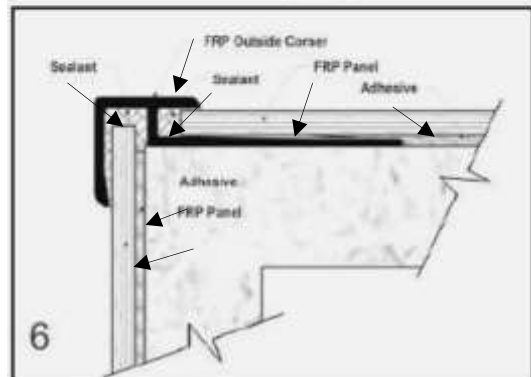
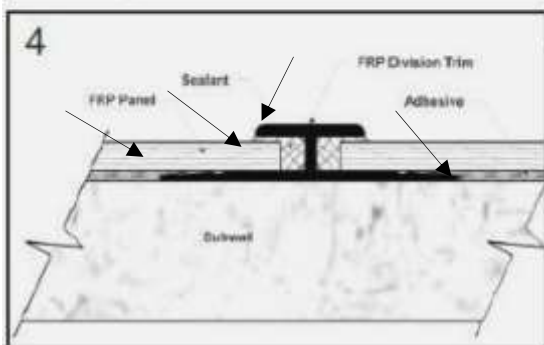
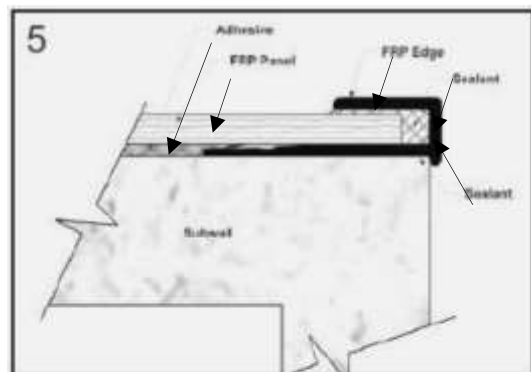
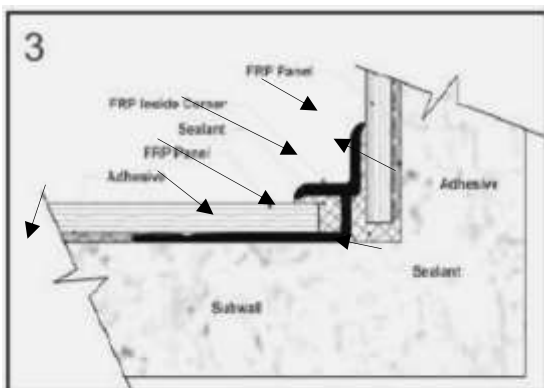

2.3.2.- Application at Tile Curb, Floor, Base Molding and Ceiling Line

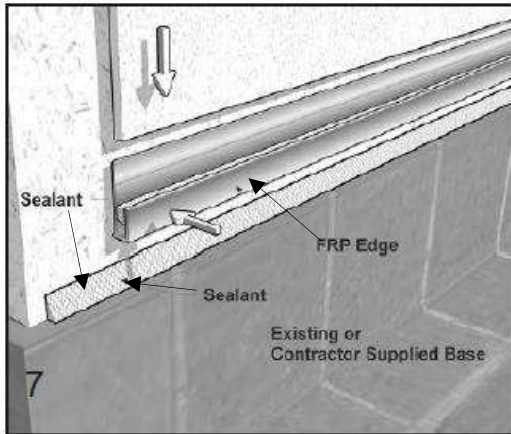

Curb must be installed first.

Apply a continuous bead of silicone sealant to the top of curb or floor line and in the Trim Molding channel.

Set Edge Trim Molding in place and fasten to the sub wall. Slip FRP Panel into Edge Trim Molding. Allow for 3,18 mm expansion space and sealant "squeeze-out".

Execute similar application at ceiling line. (see illustration 7)

2.3.3.- Application at Inside Corners

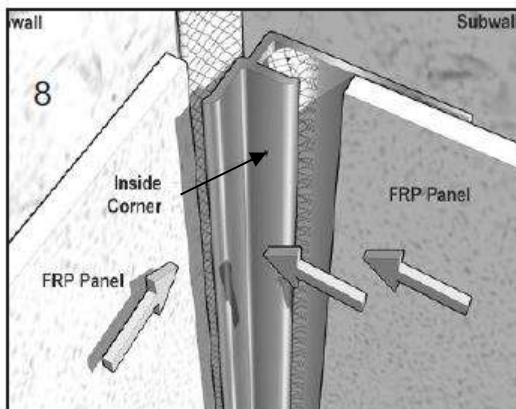

Apply a continuous bead of silicone sealant in the corner and in the Inside Corner Trim Molding channel. Secure Inside Corner Trim Molding to cover bead. (see illustration 8)

2.3.4.- Application at Outside Corners

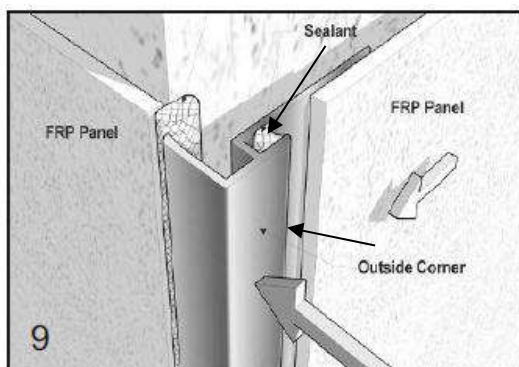

First, cut the FRP Panel on the preceding wall flush to the outside corner and install. Apply a continuous bead of silicone sealant to both Outside Corner Trim Molding channels. Secure into place and slip in the next FRP Panel. (see illustration 9)

2.3.5.- Application at Panel Divisions

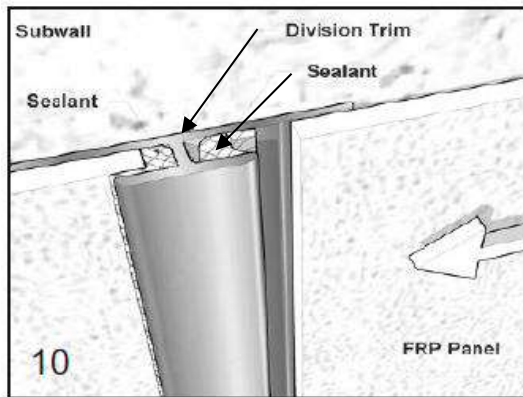

Apply a continuous bead of silicone sealant to both Division Trim Molding channels. Slip under preceding FRP Panel and secure to sub wall. Then, continue with the next FRP Panel. (see illustration 10)

Use tachuelas o grapas y / o adhesivo en las pestañas de perfil por división. Asegúrese de que haya un espacio de expansión de 3,18 mm entre el laminado y la tira central del perfil de división. Use pin tacks or staples and/or adhesive on Division Trim Molding flanges. Ensure 3,18 mm expansion space between the FRP Panel and Division Trim Molding center strip

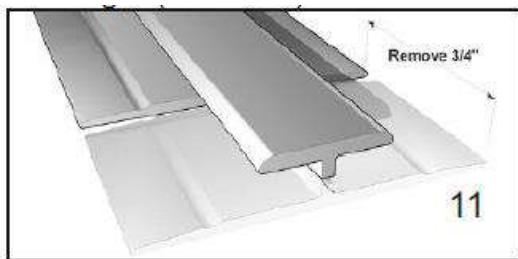

Flanges and posts of Division Trim Molding must be cut away 19,05 mm if it butts to already applied Trim Molding. (see illustration 11)

2.4.- Cutting FRP Panel

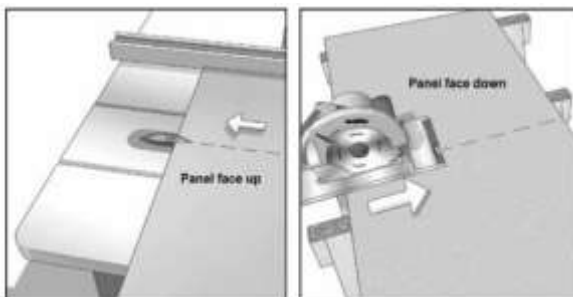

Cut FRP Panels face up with a table saw or face down with a circular saw using a fine-tooth blade.

For cutouts, drill four holes and radius all corner cuts to avoid chipping.

For small jobs, FRP Panels can be cut using a strong pair of cutting shears

2.5.- Application of Adhesive

- Always apply the adhesive to the FRP Panel, be sure the existing sub wall is porous, straight, clean, and dry. Apply over plywood or drywall that is void of excessive joint compound.
If the sub wall is not porous, Construction Adhesive should be used.
- Perform a trial to ensure acceptable adhesion and performance. Adhesive is easiest to spread at approximately 21°.
- FRP Panels must be installed while the adhesive is fresh, within 5 minutes of application. Adhesive on the FRP Panel face should be removed promptly using mineral spirits. Adhesive coverage is 19,5 m2 per 13,2 liters
- Apply adhesive to the entire back of the FRP Panel using a notched spreader or trowel. Trowel size is 4,76 mm wide x 6,35 mm deep x 12,7 mm c-c notch.
- 100% coverage over the entire FRP Panel back is required except approximately 25,45 mm at edges. Use the notches in the spreader to achieve the exact depth of adhesive. The spreader end must be kept at 90° to the panel surface. Avoid too heavy a coat. To assure proper ridges when spreading adhesive, keep notches of the spreader clean by placing it in a pail of water when not in use. Once FRP Panel is adhered to wall, apply pressure by rolling. Be sure of 100% adhesive transfer.

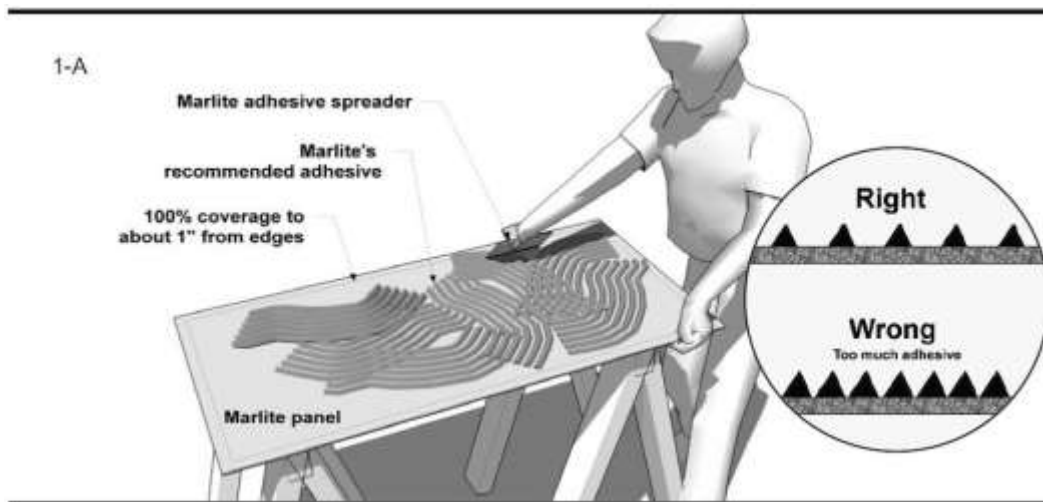

2.6.- Special tips

Pouring a layer of water on top of the Adhesive pail helps keep the adhesive fresh, reduce solvent odor, extend open time and make the adhesive easier to spread.

Note: The use of cartridge adhesives will not ensure panels stay flat and tight to the wall. **DO NOT USE Compuesto excesivo en paneles de yeso**

Si las paredes tienen un exceso de compuesto para juntas de más de 76,2 mm deben sellarse con una mezcla 50:50 de pintura de látex y agua antes de instalar los laminados. Las paredes no deberían pintarse. El incumplimiento de estos requisitos puede ocasionar una falla en la instalación.

2.7.- Application of Seam Joint

Most commonly used with Artizan FRP and Symmetrix FRP Panel

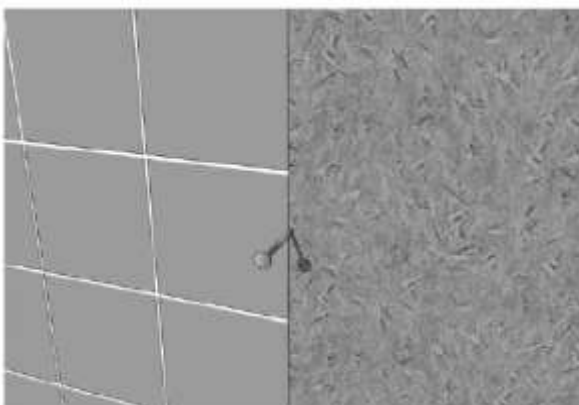

1. Use a nail for FRP Panel spacing. Dry fit before gluing to ensure groove alignment. If grooves fail to align, flip panel top to bottom

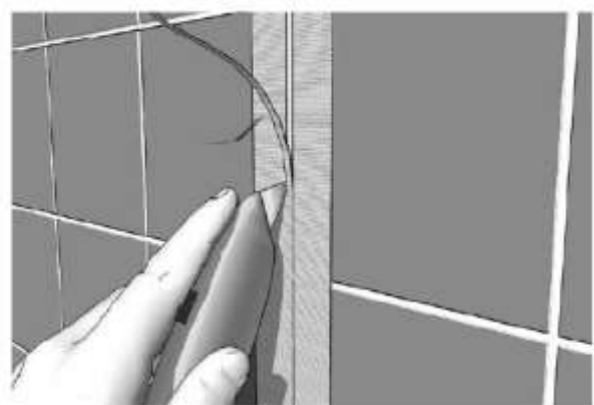

2 After adhesive sets, remove nails and apply a 50 mm or wider strip of masking tape. Trim out groove with a sharp utility knife using the panel edges as guides



3. Apply a bead of harmonizing Silicone Sealant



4. Finish the joint with a plastic spoon or finder tip. Wait one hour before removing tape. Remove excess silicone sealant.