



TECHNICAL DATA

Artizan

Smooth opaque sheet

Code: TDS-J-23

Inspection: 00

Valid from: 06/09/18

Page : 1 of 5

Product description

Artizan® has an optimal graphic reproduction on a resistant and sanitary surface. The laminate features the revolutionary BlueSky Advanced Finishing that employs high-resolution digital images with low temperature controlled curing, water-based in-line curing and VOC-free UV curing inks.

Artizan® laminates feature imitation wood, brick, stone, cement or other designs that reproduce real materials or abstract prints.

Sector

Industrial / Commercial / Health / Infrastructure / Residential

Application

Interior coating:

- Chemical plants, food processing
- Supermarketss, kitchens, restaurants
- Hospitals, laboratories, pharmacies
- Bathrooms, kitchens, laundries
- Schoools, museums, offices

Advantage

Resistant to stains, mold and mildew

High resistance. It does not crack and the joint does not deteriorate over time as it does with ceramic tile.

Great impact resistance due to its fiberglass core.

Easy to clean without the need for a brush or special tools, 100% washable

Low maintenance. Does not require external painting.

Easy to install, which means savings in time. Investment at low cost

Range

Thickness	Coating	Finish	Color	Sizes
2,3 mm	Sani-coat	Smooth Square	Monticello Anigre Monterrey Sand Verona, Tuscay	Width = 1.22m Length = 2.44 m

Colors

Monticello Anigre	Monterrey Sand	Verona	Tuscay

Coating

Sani-coat	
<p>Sani-coat applied on the sheet seals the surface of the material offering advantages in front of the traditional joint of the ceramic tile</p>	<p>Ceramic tile</p>

Finishing process with multiple steps





TECHNICAL DATA

Artizan

Smooth opaque sheet

Code: TDS-J-23

Inspection: 00

Valid from: 06/09/18

Page : 2 of 5

Technical characteristics

Properties	Rule	Value
Flexural strength	ASTM D-790	117 MPa
Flexion modulus	ASTM D-790	4.137 Mpa
Resistencia a la Tracción	ASTM D-638	55 Mpa
Tensile strength	ASTM D-638	65 Mpa
Izod impact	ASTM D-256	371 J/m
Thermal expansión coefficient	ASTM D-696	0,0288 mm/mm °C
Barcol hardness	ASTM D 2583	22
Water absorption	ASTM D-570	0,17 %
Density	ASTM D 792	1.53 g/cm ³
Fire certification	ASTM E84	Clase I/C Clase III/C
Mold and fungi resistance	ASTM D 3273	According
Service temperature	-	-40 a 54 °C (*)

* It can be discolored near heat sources, such as ovens, fryers, heat lamps and toasters, where temperatures exceed 54 °C

Standard specifications of the product

- Thickness: $\pm 10\%$
- Width: $\pm 3,18$ mm
- Length: $\pm 3,18$ mm (en lámina)
- Unbalance $\leq 3,18$ mm

Certificates

- Fire Certificate according to ASTM E-84. Classification obtained: Class I / C and Class III / C
- Certificate resistance to mold and fungi according ASTM D3273

Recommended installation

Allow the laminates to acclimate to the living room environment before installation. After unpacking, place the laminates in the room where they will be installed for at least 48 hours before installation. Install the laminates when the temperature of the room and the material is approximately 21°C.

Application is recommended over a solid backing, such as drywall or plywood. Surface to be covered must be clean, dry, solid, straight, and free from drywall dust, bumps, projections, loose plaster, loose paint, or any unsealed joint compound wider than 76,2 mm. For seams with excessive joint compound wider than 76,2 mm, seal drywall joint using a 50/50 mixture of latex paint and water applied lightly over the drywall compound only

Do not position FRP Panel joints directly over drywall or plywood joints

Cut FRP Panels face up using a table saw or face down using a circular saw

For grooved Panels, proper panel orientation is required to ensure groove alignment.

Tools needed. Sierra de mesa o sierra circular con hoja de dientes finos, pistola térmica, regla / cinta, taladro, lima, martillo, plomada / nivel, caballete / soporte. Table saw or circular saw with fine tooth blade, heat gun, ruler / tape, drill, file, hammer, plummet / ridge / support



TECHNICAL DATA

Artizan

Smooth opaque sheet

Code: TDS-J-23

Inspection: 00

Valid from: 06/09/18

Page : 3 of 5

Cleaning. For best results, engage in a regular cleaning schedule to avoid dirt build-up. In general, any mild cleaner applied with a sponge, soft bristle brush or towel is considered safe and effective. Avoid using any cleaner or stain remover considered abrasive.

High Humidity Areas. In wet or high humidity areas, the molding profiles must surround all the laminates and must be properly sealed with a continuous silicone sealant cord to ensure a tight seal.

Cutting panels. Cut FRP Panels face up with a table saw or face down with a circular saw using a fine-tooth blade. For cutouts, drill four holes and radius all corner cuts to avoid chipping.

For small jobs, FRP Panels can be cut using a strong pair of cutting shears.

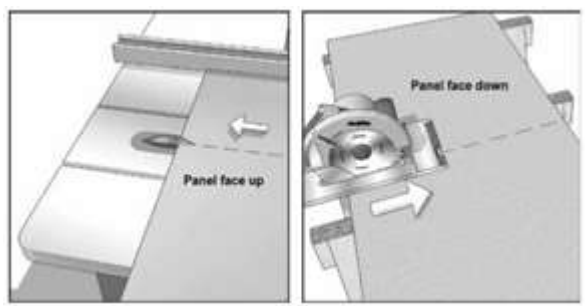

Application of Adhesive. Always apply the adhesive to the FRP Panel, be sure the existing sub wall is porous, straight, clean, and dry. Apply over plywood or drywall that is void of excessive joint compound.

If the sub wall is not porous, Construction Adhesive should be used

- Perform a trial to ensure acceptable adhesion and performance. Adhesive is easiest to spread at approximately 21°.
- FRP Panels must be installed while the adhesive is fresh, within 5 minutes of application. Adhesive on the FRP Panel face should be removed promptly using mineral spirits. Adhesive coverage is 19,5 m2 per 13,2 liters
- Apply adhesive to the entire back of the FRP Panel using a notched spreader or trowel. Trowel size is 4,76 mm wide x 6,35 mm deep x 12,7 mm c-c notch.
- 100% coverage over the entire FRP Panel back is required except approximately 25,45 mm at edges. Use the notches in the spreader to achieve the exact depth of adhesive. The spreader end must be kept at 90° to the panel surface. Avoid too heavy a coat. To assure proper ridges when spreading adhesive, keep notches of the spreader clean by placing it in a pail of water when not in use. Once FRP Panel is adhered to wall, apply pressure by rolling. Be sure of 100% adhesive transfer.

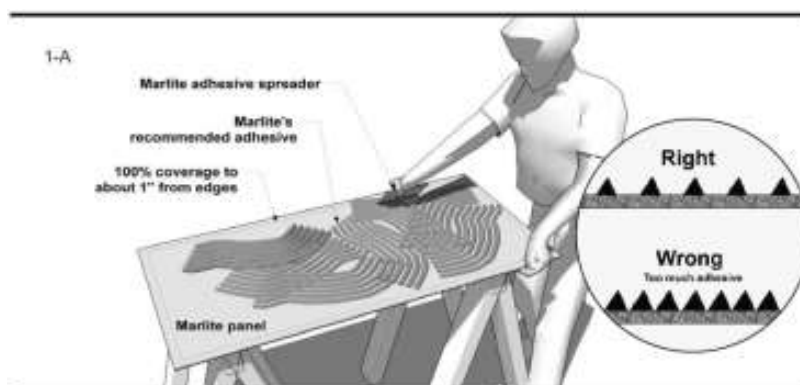

Installation Steps for FRP Trim Molding

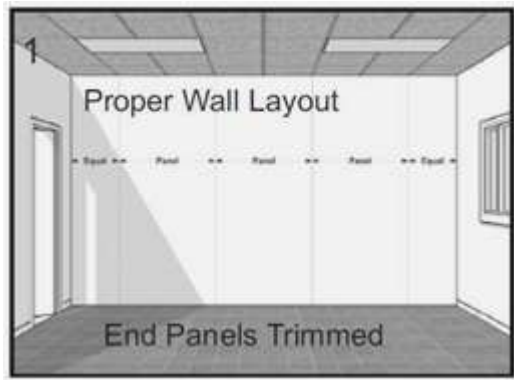

For a balanced appearance, establish a center line of area to be covered and install Division Trim Molding and work toward corners.

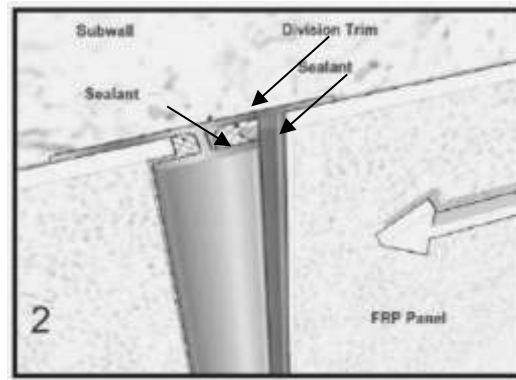

Do not fit panels too tightly into Trim Molding. Allow at least 1/8" space in all channels for panel expansion after installation is completed

Application of Seam Join

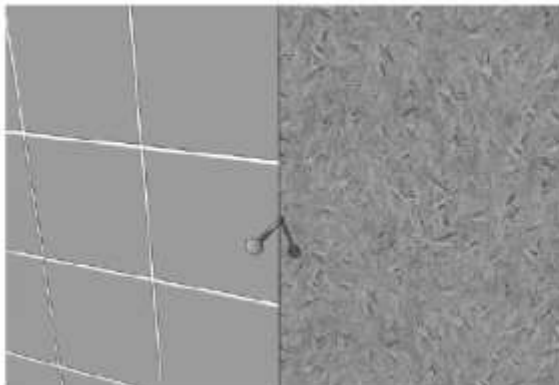

1. Use a nail for FRP Panel spacing. Dry fit before gluing to ensure groove alignment. If grooves fail to align, flip panel top to bottom

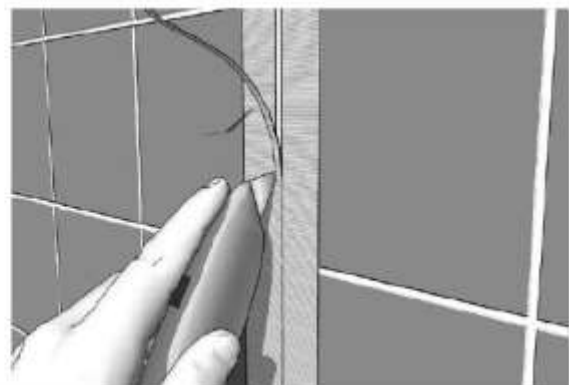

2. After adhesive sets, remove nails and apply a 50 mm or wider strip of masking tape. Trim out groove with a sharp utility knife using the panel edges as guides

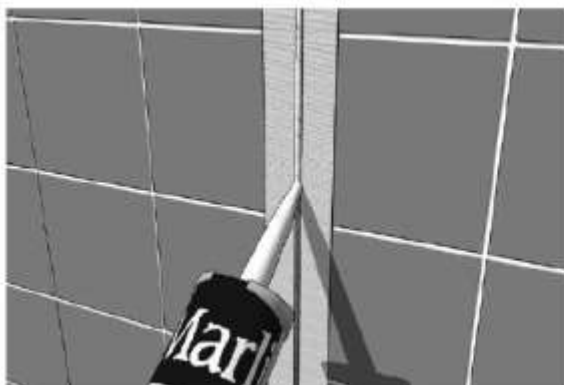

3. Apply a bead of harmonizing Silicone Sealant.



4. Finish the joint with a plastic spoon or finder tip. Wait one hour before removing tape. Remove excess silicone sealant.



TECHNICAL DATA

Artizan

Smooth opaque sheet

Code: TDS-J-23

Inspection: 00

Valid from: 06/09/18

Page : 5 of 5

Accessories

Profiles: PVC (white color) and aluminium



1. Inside corner



2. Outside corner



3. Division bar



4. Top finish

Storage Recommendations

- Store laminates indoors in cool, dry and well-ventilated areas.
- The panels must be stacked on pallets of no more than 5 pallets in height.
- Do not allow moisture to accumulate in the intermediate laminates.
- Inspect all panels carefully before installation

The information referred to in this Technical Data Sheet is based on the experience and the tests carried out by the company, without this implying any kind of responsibility for its different applications, given that Stabilit Europa does not have any kind of control over its final use.

T: (+34) 937 290 090 – T-SAC : (+34) 902 194 881

E-mail: info@stabiliteuropa.com

www.stabiliteuropa.com

